



Hook-on fork positioner with side shift, type LF

Advantages

- The pintype gives a precise control of the forks
- Low noise level
- Standard mounting in cl. 2, 3 and 4, ISO 2328
- Quick and easy mounting
- Fork positioning and side shifting in one attachment
- Now available in additional widths and fork lengths
- Fork rollers are now standard on all models



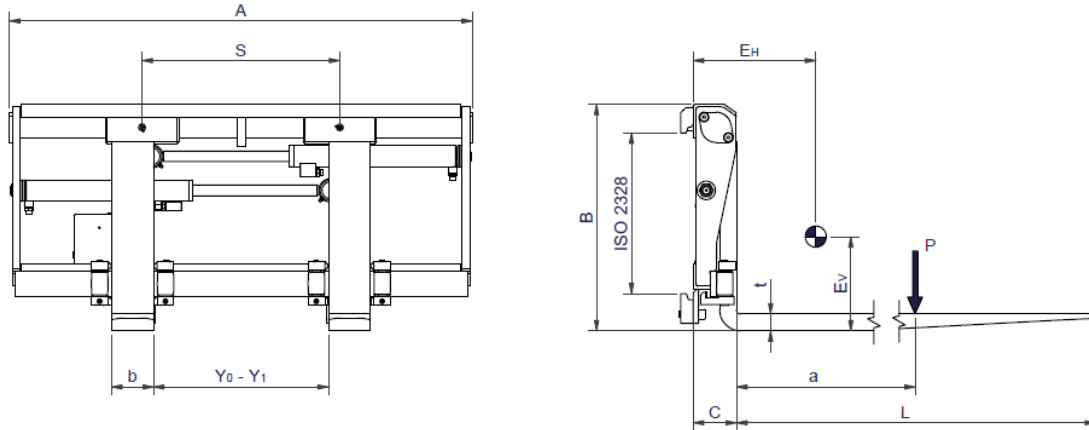

	Capacity	Load center	Width	Height	Lost load center	Center of gravity, horizontal	Center of gravity, vertical	Weight	Opening range	Side shift	Fork size/length	ISO 2328
	P [kg]	a [mm]	A [mm]	B [mm]	C [mm]	E_H [mm]	E_V [mm]	Q [kg]	$Y_0 - Y_1$ [mm]	S [mm]	b x t x L [mm]	
5LF 18 1000	1800	500	1000	530	103	219	211	162	146-746	+/- 150	80x40x1200	2
5LF 18 1050	1800	500	1050	530	103	216	213	165	146-796	+/- 163	80x40x1200	2
5LF 18 1100	1800	500	1100	530	103	212	215	168	146-846	+/- 175	80x40x1200	2
5LF 25 1100	2500	500	1100	538	103	226	219	196	156-806	+/- 163	100x40x1200	2
5LF 25 1150	2500	500	1150	538	103	223	221	200	156-856	+/- 175	100x40x1200	2
5LF 25 1200	2500	500	1200	538	103	219	223	203	156-906	+/- 188	100x40x1200	2
5LF 35 1200	3500	500	1200	636	108	227	242	258	110-860	+/- 188	125x45x1200	3
5LF 35 1250	3500	500	1250	636	108	224	244	262	110-910	+/- 200	125x45x1200	3
5LF 35 1300	3500	500	1300	636	108	221	246	266	110-960	+/- 213	125x45x1200	3
5LF 45 1300	4500	500	1300	638	122	231	250	338	108-908	+/- 200	150x50x1200	3
5LF 45 1400	4500	500	1400	638	122	226	253	348	108-1008	+/- 225	150x50x1200	3
5LF 45 1450	4500	500	1450	638	122	224	254	353	108-1058	+/- 238	150x50x1200	3
5LF 50 1400	5000	600	1400	813	122	215	334	376	108-1008	+/- 225	150x50x1200	4
5LF 50 1450	5000	600	1450	813	122	213	336	381	108-1058	+/- 238	150x50x1200	4

On stock - shipping within 24 hours (business days)

Also available with 1600 [mm] forks
Min. working pressure 110 [bar] - for full load side shift
Max. working pressure 250 [bar]
The table vaues E_H , E_V and Q are calculated

